

TEXAS HISTORICAL COMMISSION

real places telling real stories

DECLARATION OF DEDICATION FOR CEMETERY PURPOSES FOR THE CARTWRIGHT-SUNDAY CEMETERY

THE STATE OF TEXAS

§
§
§

KNOW ALL MEN BY THESE PRESENTS:

COUNTY OF MONTGOMERY

That the Texas Historical Commission, an agency of the State of Texas, does hereby certify and declare:

That the Cartwright-Sunday Cemetery, located in the WILLIAM ATKINS SURVEY, ABSTRACT NO. 3, Montgomery County, Texas and more particularly described in Exhibit A as attached hereto, has been set aside and dedicated for cemetery purposes through historic use and that such property is now occupied by human graves.

That the Texas Historical Commission has duly considered the evidence of existence and historic use of said cemetery and has listed said cemetery as a Historic Texas Cemetery, worthy of preservation.

That this dedication is subject to all the laws, rules, and regulations of the State of Texas regarding cemeteries now in effect and to those adopted after the effective date of this dedication, and is made in accordance with 13 Tex. Admin. Code Section §21.30.

This Affidavit of Dedication for Cemetery Purposes is signed and executed on this 6 day of October, 2010.

[Handwritten signature of Terry Colley]

Terry Colley
Deputy Executive Director
Texas Historical Commission

THE STATE OF TEXAS

§
§
§

COUNTY OF TRAVIS

BEFORE ME, the undersigned authority, on this day personally appeared Terry Colley, known to me to be a credible person, whose name is above subscribed, and said person swore to me the statements contained herein are true and correct.

SUBSCRIBED AND SWORN TO BEFORE ME on this 6 day of October, 2010.

[Handwritten signature of Annette Bethke]

NOTARY PUBLIC in and for the STATE OF TEXAS

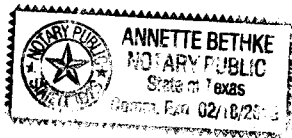

LT2-3



LT1-1-2010096678-1

Exhibit A

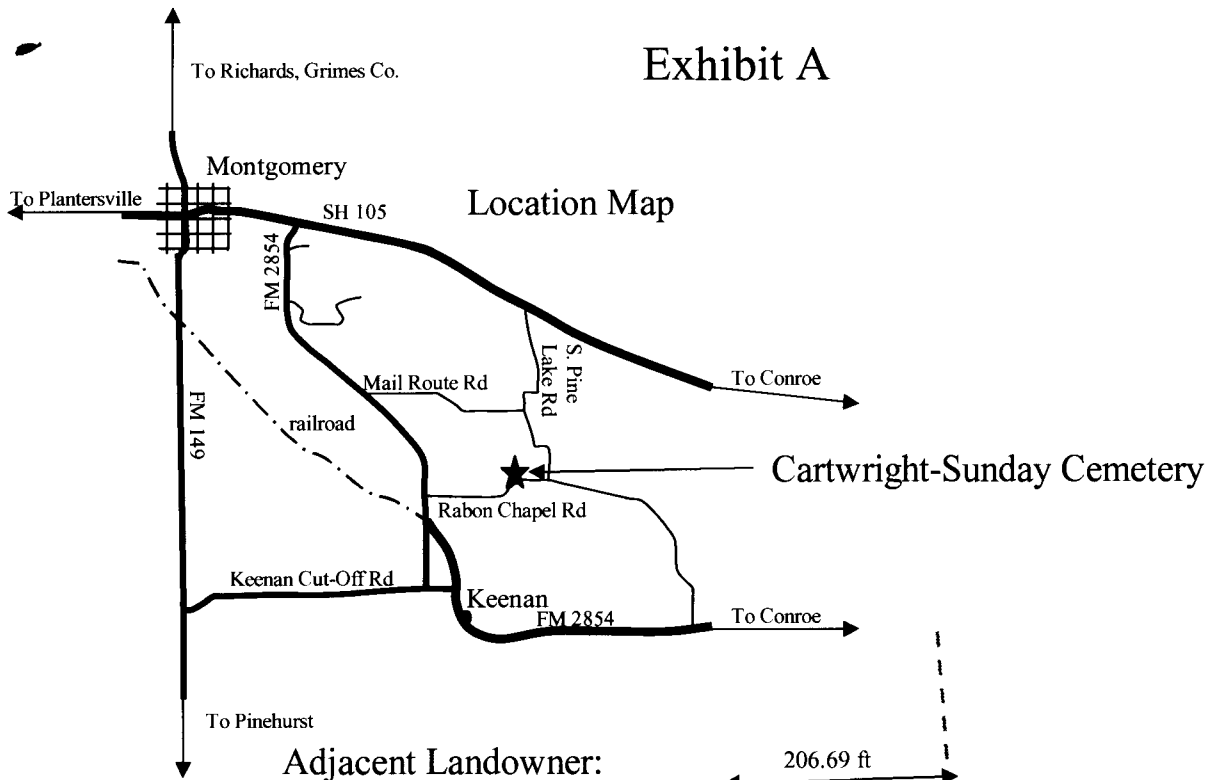

Adjacent Landowner:
Robert & Diane Kendrick

Adjacent Landowner:
Howard Family
Revocable Living Trust

Adjacent Landowner:
Estate of Ida Bell Griffith

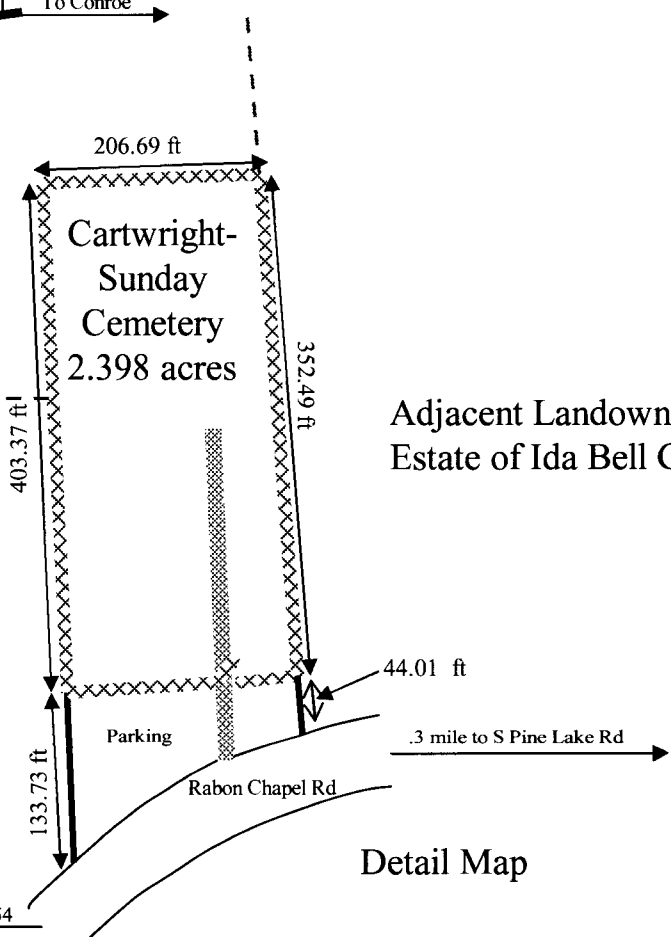

Map adopted from data provided by the applicant, the Montgomery County Appraisal District and Kenneth E. Savoy, R.P.L.S., #5730, November 16, 2009 and October 23, 2009, Conroe, Texas. See Deed Records of Montgomery County, Vol. Q, Pg. 5 and Vol. 380-01, Pgs. 157-158 Located in the William Atkins Survey, A-3, Montgomery County, Texas. UTM: Zone: 15 Latitude: 30.3438N Longitude: 95.63536W (NAD83).

CARTWRIGHT-SUNDAY CEMETERY

Also known as Rabon Chapel Cemetery and Rabon-Cartwright Cemetery
Cemetery No. MQ-C048
Montgomery County

FILED FOR RECORD

10/28/2010 11:14AM

Mark Jumball

COUNTY CLERK
MONTGOMERY COUNTY, TEXAS

STATE OF TEXAS
COUNTY OF MONTGOMERY

I hereby certify this instrument was filed in file number
sequence on the date and at the time stamped herein
by me and was duly RECORDED in the Official Public
Records of Montgomery County, Texas.

10/28/2010



Mark Jumball

County Clerk
Montgomery County, Texas

Ret: Lady E Dalton
8381 White Oak Loop
Montgomery, Tx 77315-2059